

THROUGH THE GRAPEVINE



SOWING SEEDS AND GROWING FRIENDSHIPS

TUESDAY, MAY 24 - LAKESIDE PICNIC

Arrival Social 10:30 A.M.

Lunch 11:00 A.M.

Meeting 11:45 A.M.

at the

Trawick Pavilion on the shore of Grapevine Lake

Val Reed, Coordinator

You are invited to celebrate a successful Garden Club year at the Annual Spring Membership Luncheon. Dine on the many delicious salads and desserts provided by members. Enjoy the company of gardening friends, witness the installation of the 2011-2012 officers and visit with our scholarship award winners. It will be a casual affair, and we will lunch on picnic tables under the pavilion.

RSVP, Yes only - Linda Barraclough (Yearbook page A-3) by May 17 and designate your contribution, dessert or salad, for the luncheon. Members have the opportunity to invite a guest. Please submit your guest's name to Linda.

The dues for the upcoming fiscal year, June 1, 2011, through May 31, 2012, may be paid at the luncheon. Make checks payable to the Grapevine Garden Club. Individual Memberships are \$30 and Family Memberships are \$35.

MAY 2011

PRESIDENT'S MESSAGE



What a wonderful plant sale! It went as “smoothly as a well-oiled machine.” Thank you each and every one who had a part in making it a success. Everyone who helped knew their job and did it well. Special thanks go to Karen Rice and her team.

Our garden club year is coming to a close. We have had marvelous programs, great trips and tours, yummy food at meetings, special luncheons, important civic projects, wonderful fellowship, and lots of laughter. We earned meaningful awards and volunteered at city events. I hope each of you made new friends and had the chance to benefit from your garden club friends from over the years.

I have enjoyed being your president. It's not a tough job when there are so many willing members who so willingly take on leadership positions. The next garden club year will be another opportunity to continue the traditions of this wonderful organization. I hope each of you will be a part of it.

- Sarah Erickson, President



CALENDAR OF EVENTS

Date	Event	Location
May 18	Ft Worth Garden Club Council Meeting	Ft Worth Botanic Garden
May 21	Ft Worth Herb Society Festival	Ft Worth Botanic Garden
May 24	GGC Spring Luncheon	Grapevine
June 4	North Texas Daylily Society Flower Show	Ft Worth Botanic Garden
June 9	GOG - Botanical Research Institute of Texas (reservations only)	Ft Worth, near Botanic Garden



TEXAS GARDEN CLUB SPRING CONVENTION AND STATE AWARDS

The Texas Garden Club (TGC) Spring Convention was held in El Paso a few weeks ago. At the convention, Kathy Cox was installed as the 2011-2013 TGC President and State Awards were presented to many garden clubs. Polk County Garden Club in District III was named Garden Club of the Year. The runner up Garden Club of the Year was Hondo Garden Club in District VII. While the Award committee does not officially recognized the next runner up, I know from a good source, that Grapevine Garden Club came in third for Garden Club of the Year. Congratulations to both Polk County and Hondo Garden Clubs.

Also during the TGC convention, the Grapevine Botanical Gardens & Greenhouse project was approved by the incoming Executive Board of Texas Garden Clubs as a contributing project until 2013. That means garden clubs across the state can make donations through TGC to the Grapevine Botanical Gardens. In return for their donations, they will earn points on their clubs' rating reports. Ginger Jones, incoming District II President, made the presentation to the TGC Board. She said they were sincerely impressed with all the educational programs conducted at the Pewitt Pavilion and our docent tours. Look for an announcement about the GV Botanical Gardens project in a future Lone Star Gardener magazine.

When you look at the list of District and State awards below and on the next page, you should feel very proud to be a member of the Grapevine Garden Club. These awards demonstrate the Club's sense of civic and community service and a commitment to the education of the youth in our community. Our hats are off to the Project Coordinators and GGC members who contributed to these projects. Next year let's work to be the first place Garden Club of the Year!

Award Name	Project Name and Coordinator	District II Place & # points		TGC Place
TGC Community Service	Seed Money. Paula Jones & Civic Committee	1 st	100	1 st
TGC Arbor Day	Arbor Day celebration at Oak Grove Baseball Complex. Lisa Grove	1 st	98	1 st
N-48A Horticulture Therapy	West Texas Street Project. Suzi Guckel	1 st	100	1 st
N-43 Butterfly	Butterfly Flutterby. Barbara Oldani	1 st	99	1 st
N-13A Publications	Newsletters (January, April & May, 2010 submitted). Kathy Dohrer	1 st	100	1 st

(Continued)

MAY 2011

TEXAS GARDEN CLUB SPRING CONVENTION AND STATE AWARDS, cont.

Award Name	Project Name and Coordinator	District II Place & # points		TGC Place
N-8 Youth Horticulture	Redbud Tree distribution to 3 rd grade students. Laura Ball	1 st	90	1 st & \$15 check
N-16A Yearbook	2010-2011 Yearbook . Chuck Voelker	1 st	100	1 st
N-13B Publications	Membership Brochure . Elayne Vick	1 st	100	2 nd
President's Report	Sarah Erickson	1 st	100	2 nd
Gold Club Rating Report	Lists the Club's activities and programs. Barbara Atkins	Gold, 760 points		2 nd
N-7 Special Achievement	NGC Girl Scout Native Plant Patch . Lisa Grove	2 nd	86	
TGC Mini Garden Center	Kiosk in front of Mitchell House. Ileana Craft	3 rd	80	
N-74 Outdoor Classrooms	Preschool classes taught at GV Botanic Garden. Joyce Quam & Valerie Reed	3 rd	84	
TGC Club Service	GGC Total number of Volunteer Hours	1243 points		
	"Plant it Pink"	Director Citation		

Contributions to:

National Garden Club Projects	
Monarch Watch	\$20
World Gardening – Haiti	\$20
"Penny Pines" Plantation Project	\$68
Texas Garden Club Projects	
Nature Conservancy of TX	\$20
Holistic Garden Project	\$20
TGC Headquarters	\$20
District II Projects	
Arbor Day Fund	\$40
Scholarship Fund	\$40
"Plant It Pink"	<u>\$25</u>
Total Contributions	\$270



- Linda Krimm, Award Committee Chair

MAY 2011



National Garden Clubs, Inc.

NATIONAL GARDEN WEEK

PROCLAMATION

Whereas, Gardeners have a passion for nurturing the beauty and resources of the earth through the planting of seeds, the care of all plants and the riches of their efforts; and

Whereas, Gardeners seek to add beauty, splendor, fragrance and nutrition to our lives through the growing of herbs, vegetables, foliage and flowers; and

Whereas, Gardeners work to preserve our country's traditional spirit of independence and initiative through innovation and hard work; and

Whereas, Gardeners advocate the importance of all creatures, large and small, that share our world and their roles in a balanced and productive ecology; and

Whereas, Gardening furnishes a challenging and productive activity for many citizens, for those just learning as well as those having years of experience; and

Whereas, Gardening promotes a healthy lifestyle that last a lifetime, helps reduce stress from other areas of our life, teaches that rewards can come from diligent efforts; and

Whereas, Gardening enables members of Garden Clubs across the nation and the world to serve others in the communities where they reside and work;

Now, Therefore Be It Resolved that in an effort to acknowledge the importance of Gardening and the numerous contributions of Gardeners, the National Garden Clubs, Inc. designates the week of June 5-11, 2011 as National Garden Week.



Renee D. Blaschke, 2009-2011 President, NGC, Inc.

Grapevine Garden Club is celebrating National Garden Week with a field trip to the Botanical Research Institute of Texas (BRIT).

MAY 2011

APRIL GARDEN TOURS

One of the prime GGC membership benefits is the many members' garden we are privileged to view in the spring. Our tour directors take us there when members' best efforts are on view. In April six tours provided the inspiration we all need to bring our own gardens to their fullest.

On April 21 we gathered early for the drive to Ed and Joetta King's delightful garden, designed without grass for minimal upkeep but with deep space and shade for many perennials. Joetta's added bonus is a sunny front corner full of bluebonnets and other wildflowers.

Next we were privileged to again be invited to Dr. Pat and Kathy Stanton's huge, highly developed acreage with fascinating statuary and many trees, shrubs, and flowers, plus a gorgeous view to a large neighborhood pond. His open garden that day received visitors from many local organizations, all escorted and directed by students from the Hill School in Grapevine. Refreshments awaited us on the Stanton's spacious covered porch. A steady but light drizzle did not dampen our delight that day at the Stanton grounds.

Our last stop that day was Steve and Laura Purdy's garden where we followed stone pathways in the backyard to view a delightful water feature and beautifully selected roses and perennials. Again, the absence of grass in the back area provided the perfect palette for their garden.



Joetta King hosting tour
of her garden.



Steve and Laura Purdy's garden



Listening to Dr. Stanton



Photos by Pam
Braak and Sandy
Kancavicus

One of several
peacocks
residing at Dr.
Stanton's home.

(Continued)

APRIL GARDEN TOURS, cont.

After the general meeting on April 26, members toured three of our favorite member gardens. First was Sylvan Sigler's enormous iris patch. This year the spotlight was on her many pink, frilly poppies. All members asked for seeds of this lovely early spring charmer. Our next stop was the country garden of Peggy Harris where her red amaryllis took the starring role. A ten-mile drive to Keller led us to Doris Hill's large shady back garden with its many comfortable chairs and tables and sofas on several decks for enjoying our sack lunches on a perfect spring day. The highlight of her acreage is a greenhouse-shed with sides made of old doors. Like something out of Alice in Wonderland, the garden shed strikes just the right note in a lovely landscape. On the side it is mounted a homily: "As for Me and My House, We Will Serve the Lord." Truly it does.

- Elayne Vick

Photos by Joetta King

Sylvan Sigler's
Garden



Peggy Harris'
Garden

Doris Hill's
Garden



MAY 2011

MORE GGC ACTIVITIES IN APRIL

West Texas Street Project - April 12

Photos by Joetta King



Pam Braak spreading mulch



Eloise Myers planting dianthus

Ft Worth Nature Center and Refuge - April 19

Photos by Ella Barber



FLOWERCADE



The Grapevine Garden Club had another successful year at the Flowercade Flower Show, held at the Fort Worth Botanic Garden. Flowercade consists of two divisions: Horticulture and Design. Thirteen GGC members participated in the Horticulture Division and won 23 first place ribbons, 17 second place, 3 third place and 1 honorable mention ribbon. Linda Krimm earned a green rosette “Arboreal” award for her Bird Of Paradise Bush sprig. Rachel Clark, who also served as the Chairman of the Horticultural Division, received an orange rosette “Award of Merit” for her bronze-leaved canna.

The members participating in the Horticultural Division were Rachel Clark, Joan Stewart, Barb Atkins, Joetta King, Peggy Harris, Anita Hilfiker, Linda Krimm, Karen Rice, Paula Wilbanks, Mary Ledoboer, Suzi Guckel, Sarah Ericson, and René Herndon.

Four GGC members participated in the Design Division. For the first time we had a “Novice Challenge” to those who had never before entered a design in Flowercade. The theme was “Lunch in the Garden” with the task of designing a single place setting accented with a flower arrangement. D’Ray Rice won first place (photo, right), which included a rosette for “Special Flower Show Award” and a beautiful crystal bowl. The remainder of our group also received awards including Lindle O’Neil (3rd place), Carmen Drew (honorable mention) and me, Rene Herndon (2nd place). I am looking forward to even more participation next year.



Once again, we would like to thank Joan Stewart for the use of her greenhouse while we prepared the horticultural specimens for Flowercade. She has been a gracious hostess for many years now and those who have walked up her drive to the greenhouse are envious of her spacious, light-filled work space.

I want to encourage those of you who haven’t participated in Flowercade to do so next year. It takes very little effort and is such a rewarding experience.

- René Herndon, Flowercade Coordinator

A note: We use several sizes of green bottles to stage our blooms.

We have enough of almost every size, thanks to all of you through the years. However, there is one type we need: a green bottle with a neck large enough to hold an amaryllis stem, which is very thick. Please keep your eyes open for a green bottle with a 1 ½” to 2” opening. You will be our hero if you find one.



MAY 2011



CLASSES AT THE GRAPEVINE
BOTANICAL GARDENS
AT HERITAGE PARK
(Pewitt Pavilion)

May Flower Fun



Tuesday, May 17.
4:00 – 4:45 P.M.

Tiptoe through the flowers in your imagination as we create paper flowers and cup flowers, and then we plant them.

Caterpillar Mural

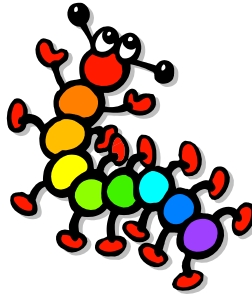

Tuesday, June 21.
4:00 – 4:45 P.M.

Look at live caterpillars, learn about their life cycle, and then create a caterpillar mural.

Sunflower Shower



Tuesday, July 19.
4:00 – 4:45 P.M.

Sunflowers live from seed to seed in only one season. They are beautiful and the seeds can be roasted into great snacks. Learn more about them and their life cycle.

All sessions include a story time and craft activity.

MEMBERS WITH BIRTHDAYS IN MAY

Maureen Bittick
Shannon Bordelon
Pam Braak
Chelsea Chance
Carol Crosser
Susan Cullen
Sarah Erickson
Barbara Hilliard
Marci Junge



Jerene Kilpatrick
Dorothy Launius
Debi Meek
Carol Milner
Debbie Monahan
Pauline Robbins
Sylvan Sigler
Lonna Tweedy
Miriam Ward

MAY 2011



PLANT SALE 2011 WRAP-UP

What does it take to make a successful plant sale? Nice plants, good weather and a wonderful group of volunteers! GGC will be able to add over \$8,000 to the Scholarship and Civic funds for next year. Wow! This could not have been accomplished without the tireless efforts of the many volunteers who worked to make this happen.

A special thanks go to plant sale coordinators and their teams - Barb Munn for retail, Val Reed and Chuck Voelker for heirlooms, Linda Krimm for plant sale day set-up and day-of events, Pat Mingus and Gloria Land for publicity, Joetta King for plant sale consultants and heirloom set-up, Elayne Vick for plant sale signage, Pam Braak for cashiers and assistants, Lisa Grove and Kevin Mitchell for tree farm and numerous other elements. These chairmen all had great support from their terrific teams. A big thanks go to the many other members, spouses and friends who helped, donated plants, and supported the sale by buying plants!

- Karen Rice - Plant Sale Coordinator



GGC shoppers at the Tree Farm post sale

YEARBOOK UPDATES : PLEASE CHECK YOUR INFORMATION

While most members of the Grapevine Garden Club are enjoying a break from all the club activities, the new board members and project coordinators will be preparing next years yearbook. Please check your contact information in the Club Members section to ensure that it is correct. Send any corrections to Harriet Perrello, Membership Chairman (Yearbook page A-40). Thank you.

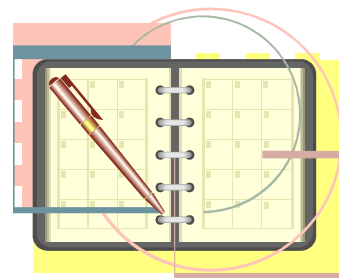

- Chuck Voelker, Yearbook Chairman

MAY 2011

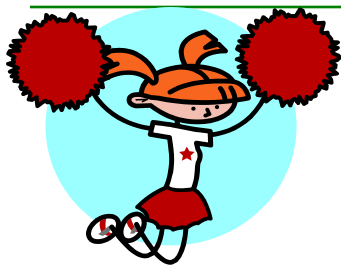

WELCOME TO OUR NEW MEMBERS WHO JOINED IN APRIL 2011

Peggy	Anderson	Grapevine	Linda	Runnerstrom	Azle
Ron	Anderson	Grapevine	Kimberly	Singel	Grapevine
Carolyn	Chance	Colleyville	Matthew	Singel	Grapevine
Chelsea	Chance	Colleyville	Marcie	Smith	Roanoke
Susan	Lively	Grapevine	Rusty	Smith	Roanoke
Debi	Meek	Grapevine	Annita	Weidenbach	Roanoke
Mike	Meek	Grapevine			

FABULOUS FOLIAGE

By Toni Moorehead, Master Gardener
<http://signaturegardens.blogspot.com>

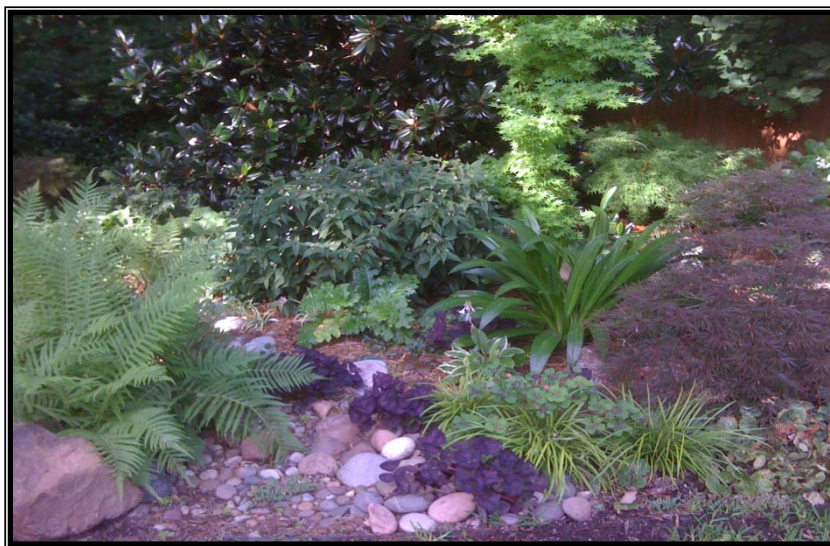

"They" say the longer you garden, the more you will appreciate the foliage in your garden.

(Continued)

FABULOUS FOLIAGE, cont.

A couple of years ago I created a foliage-only bed in my backyard. I'm not sure if that means I've finally "arrived" at some level of maturity in the world of gardening, or if I have just succumbed to the fact that my backyard is getting shadier and profuse blooms are no longer an option. Yes, some of those plants in my foliage-only garden do bloom, but their lovely leaves of varying shades, textures, and shapes are their main claim to fame.

I always tell my clients who are lamenting the fact that they can't have a riot of colorful blooms in their shady areas that they need to learn to embrace foliage plants. Don't get me wrong, I love blooms as much as anyone, but blooms can be fleeting. Foliage adds enduring interest, texture, contrast, and color. Some months we are hard-pressed to find any blooms in our gardens, but we can always count on foliage. When there is less completion from blooms, we can appreciate the foliage in our gardens all the more. The bottom line is that foliage plants give us a lot of "bang for our buck."

Spring foliage gives our gardens a fresh look, autumn leaves add color, and evergreen foliage adds structure and texture to our gardens through the winter.



Spring foliage of Hosta
'So Sweet' and
Viola Odorata



Fall color foliage of
Japanese Maples



Evergreen foliage of
'D.D. Blanchard'
Magnolia

Trees, shrubs, perennials, and groundcovers sporting foliage of **lime green**, **dark green**, **gray green**, **burgundy**, **variegated**, **spotted or striped**, add color to our gardens.

Differing textures (glossy, matt, fuzzy, smooth, crinkly, coarse, fine) and varied shapes (strapleaf/grassy, dissected, rounded) add interest and complement blooms.

(Continued)

FABULOUS FOLIAGE, cont.



Spotted foliage of
Farfugium japonicum
'Aureomaculata' (Leopard
Plant)

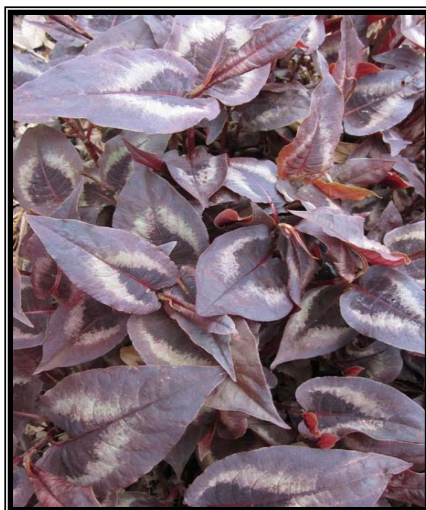

Burgundy foliage of
Persicaria 'Red Dragon'



Lime green foliage
of 'Peedee Ingot'
Liriope



Glossy foliage of Fatsia
(Japanese Aralia)



Strapleaf foliage of 'Tropical
Giant' Spider Lily



Fuzzy gray foliage of 'Helen
von Stein' Lamb's Ear

*Wow, with all those options and combinations,
who needs blooms!*

The next time you want to add some color or interest to your garden, think beyond the blooms and incorporate some fabulous foliage.

Enjoy your gardens...sans blooms!