

February 2012



THROUGH THE GRAPEVINE

February 28, 2012

Stacy's Furniture & Accessories

Community Room, 3rd Floor 1900 South Main, Grapevine

Social 9:30 A.M. Meeting and Program 10:00 A.M.

*We thank our members for continuing to carpool and to park in the outer slots
to allow Stacy's customers to park near the store entrance.*

THANK YOU TO OUR HOSTESSES: Chair, Joan Kowalski, Rachel Clark, Lisa Grove, Pat Mingus, Lindle O'Neil, Shari Stanfield, Sharon Swagerty, Edie Williams

Grapevine Garden Club February Program

Tim Doogs from Tim's Landscape and Garden Center will speak about landscape lighting. See the February monthly calendar and program page in the GGC Yearbook for more details about Mr. Doogs' program.

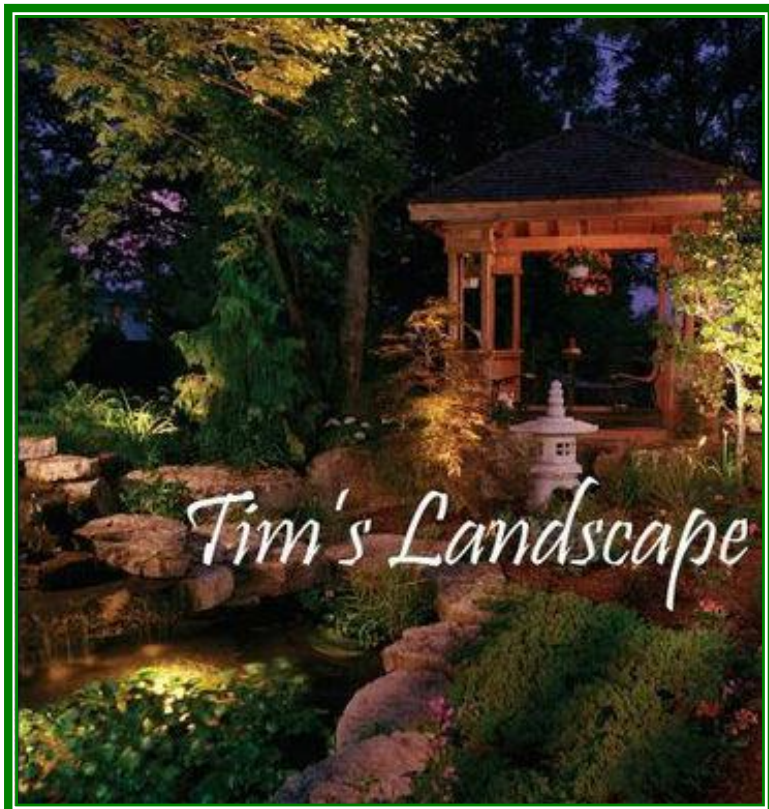

President's Message

An Annual Election, a Busy Spring, and...Broccoli

Thank you GGC members for the opportunity to serve another year as your president. Our garden club group is really easy to lead because everyone contributes to our activities and enjoys what we accomplish. Our spring will be busy with the upcoming convention, Gardeners on the Go tours, Flowercade, the plant sale, the scholarship award selection, docent opportunities, West Texas Street work day, Red Bud tree program, and more interesting monthly program speakers. And that's just some of what we will be doing!

At the January meeting, one of the members came up to me and expressed excitement that her "Suburban Salad" broccoli plant from last fall was forming a head. Mine has, too! Who knew we flower gardeners could actually succeed at vegetables. And my bok choy and red cabbage plants are still brightening the garden. The lettuce is gone now but was great to pick fresh and have as a wilted lettuce salad. Yum. I will be trying some more varieties of vegetables this spring and summer. And yes, I do like broccoli.

✿Karen Rice



Sally Beaumont Lee

Save the Dates!

Date	Event	Location
February 15	Garden Club Council Fort Worth	Fort Worth Botanic Garden
February 17 – 20	Great Backyard Bird Count	Your own backyard!
February 27, 2012	Spring District II Convention	Fort Worth Botanical Gardens
March 3 – 4	African Violet Show	Fort Worth Botanical Gardens
March 3 – April 8	Butterflies in the Garden	Fort Worth Botanical Gardens Conservatory
March 17	Fort Worth Orchid Society Sale	Fort Worth Botanical Gardens
March 21	Fort Worth Iris Society Sale; Spring Plant Sale	Fort Worth Botanical Gardens
March 22 – 24, 2012	Spring Texas Garden Club Convention	Grapevine Convention Center & Lancaster Theater
May 4, 2012	GGC Redbud Tree Program	Grapevine Colleyville ISD
May 12, 2012	GGC Sale of Heirloom Plants	Grapevine Botanical Gardens
May 22, 2012	GGC May Luncheon	Trawick Pavilion, Grapevine Lake

Connie Bacon
 Dave Buhr
 Marge Carpenter
 Margaret Collins
 Sue Dake
 Dee Gates
 Richard Guckel
 Cynthia Keeton
 Barbara Munn

February Birthdays



Lindle O'Neil
 Edith Pewitt
 Dan Reed
 Valerie Reed
 Marcie Smith
 Roy Stewart
 Annita Weidenbach
 Joyce Wuetig

Caladiums – Great for Colorful Summer Foliage

It's time to order those wonderful Caladium bulbs for bright summer color. Brochures and order forms will be available again at the February GGC general meeting. We will be ordering from the same company as the last three years with similar choices. Your caladium bulb order should be accompanied by cash or a check and will be required no later than **February 24, 2011**. GGC will offer six varieties, available in orders of 10 or more bulbs. Or get together with a friend and share a box – available in 100 and 200 count. The bulbs will be on sale for \$.55 a bulb, minimum 10 bulbs (\$5.50).

☞Theresa Kay Thomas



Razzle Dazzle Raffle

We are getting closer to the big event in March, the Texas Garden Club State Spring Convention. Wow that is a long title! Maybe using the acronym TGCSSC would have been nice with a few vowels! The items for the baskets are being collected and I would LOVE (it is the Valentine month) to have all items secured by the **February 28th** general meeting.

- ♥ So far the items donated have to do with the *wine basket*, what a delightful surprise. We have a cork trivet, chocolate liqueur, wine, cheese plate, a wine opener set, cheese utensils, wine glasses, and a wooden carving board. Now we just need to step it up a notch and continue adding to the basket with some wine jewelry, cocktail napkins, some wonderful cheeses and crackers, and a wine sleeve.
- ♥ The *bath basket* still needs bath oils, fizzing soaking powders, bath sponges, lotions, perfume, bath slippers or flip flops, and a bath wrap (towel).
- ♥ Our *travel basket* still needs a small canvas “overnight” bag, a \$25 Barnes and Noble gift card, a scarf (like a pashmina), a compact umbrella, and a sun visor.
- ♥ Our *home basket* has already been completely donated.

I really appreciate all of you and know I will be inundated with your precious gifts at our next meeting. You are definitely my Valentine! If you have any questions, contact me.

☞Valerie Reed

2011-2013 The National Garden Club President's Project,
PLANTINGS for PUBLIC and SPECIAL PLACES
recognizes outstanding projects in three categories with MONETARY AWARDS.

Apply directly to the appropriate chairman using the form found on NGC website: www.gardenclub.org

Gardens with Edibles: Chairman Pat Rupiper arupiper@bright.net

1st place - \$300

946 Crouse Chapel Road

2nd place - \$150

Chillicothe, OH 45601-8842

3rd place - \$100

Container Gardens: Chairman Susan Robinson rerob@mac.com

1st place - \$300

173 Witherell Lane

2nd place - \$150

Manchester Center, VT 05255

3rd place - \$100

Trees and Shrubs: Chairman Lissa Williamson erw510@aol.com

1st place- \$300

403 St. Ives Drive

2nd place - \$150

Severna Park, MD 21146-1015

3rd place- \$100

Participate in the NGC President's Project, **PLANTINGS for PUBLIC and SPECIAL PLACES**. WIN in each category. Visit www.gardenclub.org for more details and to apply directly to the individual chairman listed above.

DEADLINES are APRIL 1, 2012 and APRIL 1, 2013

Complete the form on the NGC website as projects are completed for recognition and a monetary award. Applications may be submitted to chairmen electronically or by mail. For further information contact Coordinator Betsy Steele at betsysteele@truvista.net or 803-789-5451.



Digging Party for Pass-Along Plants

Each spring the club sponsors a community plant sale to benefit the club's scholarship and civic projects. It's time to start thinking about this annual spring plant sale to be held on Saturday, May 12th at the Grapevine Botanical Gardens, and our members' only sale which will be on Friday, May 11th. In preparation for those days, we need to take a look at our gardens and see what perennials we have that we would like to donate to the sale and start digging.

Digging parties are scheduled and members get together where there are extra plants to be divided, thinned, and potted for sale. These pass-along plants are a big part of what our customers look for at our sale each year. There will be a sign up sheet for a "digging committee" at the next general meeting. We need volunteers to help dig up and pot plants in members' gardens for the coming sale. These are fun events where you are working side by side with friends in the garden for about an hour. If you are a new member, this is a great way to meet new people and learn new information about plants.

If you would like, we can reserve a digging party for you. Please contact Paula Wilson, Plant Chair. Are you having health issues and you can't dig or pot? Can you write plant names on a stake? We have a job for you! Sign up today or contact Paula Wilson.



2008 Barb Munn, Joyce Quam & Suzi Guckel



2008 Joyce Quam



2009 Diana Pospisil, Marion Brekken & Bev Bravo



2009 Chuck Voelker and Susan Boelens

We are asking members to hold these newly potted plants at their homes this year and nurture them until a couple of weeks before the Spring Plant Sale. Then we will gather them all at the Tree Farm for final preparations. For those of you who would rather pot up your own donations, one gallon pots and landscape mix is available to you at the Tree Farm, or you can contact Paula Wilson for these materials. Your plant donations are so important to the success of our sale. Our customers truly want these tried and true plants because they trust our expertise. Please join us!

☞**Paula Wilson**
Digging Party Coordinator

Great News!!

Once again Better Homes and Gardens magazine is going to furnish those who renew their annual 2012-13 membership in the Grapevine Garden Club with a free, 1-year subscription. This fabulous offer also applies to new members who join. Membership renewals will begin April 1st. An area will be set up for this purpose at the April 24th general meeting or you may submit your dues to our post office address, PO Box 811, Grapevine TX 76099.

**Better
Homes
and Gardens.**

☞**Harriet Perello, Membership**

New Housing Start-Ups in Grapevine

When Melissa Niemiera called to see if we had a project for Troop 1171 to do that would help them earn their World Conservation Award, my mind was full of possibilities. Having a dedicated bird sanctuary area in the Botanical Gardens at Heritage Park presented the most worthy project for them to take on.

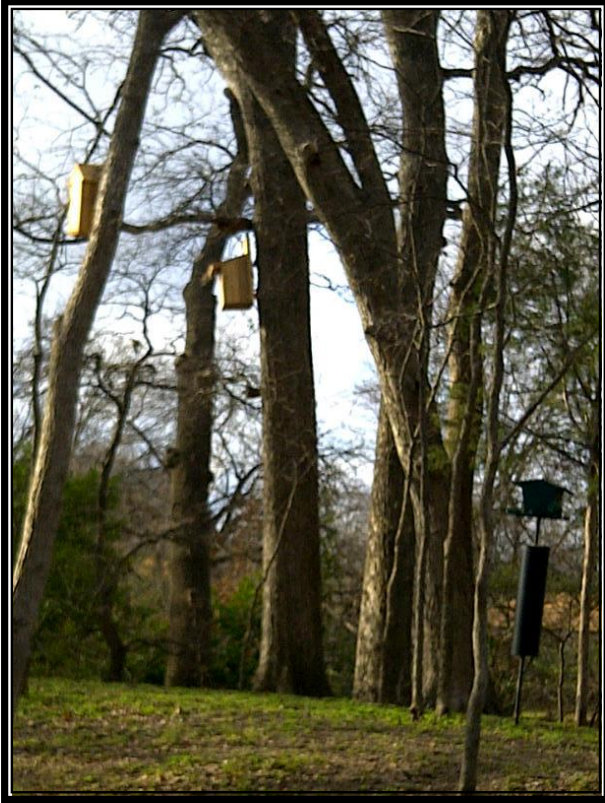

We immediately started researching designs and looking through scrap materials suitable for this purpose. City employee, Mark Lockwood, began cutting out kits for the scouts to assemble and install. Melissa was quick to secure donations of wood from local home improvement stores as well as purchases of wood glue and nails. When we were finished, we had two screech owl nesting boxes and ten bird houses of various designs. Mark predrilled them for ease of assembly. He and GGC member Chuck Voelker also made sure each scout had the opportunity to run the power drill needed to assemble the owl boxes.

On January 20, 2012, the scouts arrived at the Grapevine Botanical Gardens and assembled at the Ed and Edith Pewitt Pavilion to get started. As Troop 1171 began to arrive, Docent, Barb Atkins, used bird flash cards provided by Melissa Niemiera to captivate scouts while Master Gardener/Docent Sara Stover used a bird call book to play back each bird's song. Many of the scouts recognized the birds as some they see and hear in their own yards.

When all scouts were present, docents, GGC members, and master gardeners helped scouts assemble the kits. The scouts took great delight in making structures that the birds would be proud to live in. Upon completion of the structures, we added twigs and Spanish moss to the roofs for the birds to carry inside and use for nesting material. After finishing the structures, GGC President Karen Rice master gardener Carol Tipton, and docent Cindy Crook helped the scouts refill all bird feeders in the garden as the rest of us identified locations for the new homes.

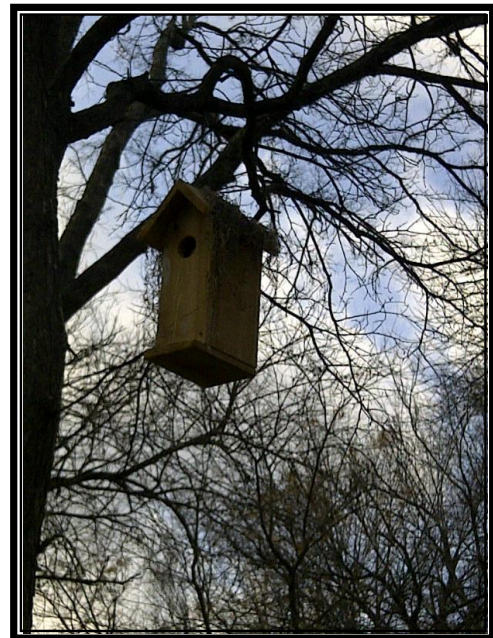

Finally, we installed the bird houses. Ladders were required and climbing was a necessary part of this project. Parents, scouts, and garden volunteers were able to add to the bird sanctuary just in time for winter, providing shelter and new homes for our feathered friends, while allowing Troop 1171 to earn a most prestigious award—a symbiotic relationship for all involved. Scouts then filled and hung a copper finch feeder made by Mark. We were in the Gardens yesterday, amazed by all of the American Goldfinches perched on it. We hope you will visit soon to see the new homes and the birds beginning to inhabit them.

✂Lisa Grove
Grapevine Botanical Gardens



Texas Garden Clubs Spring Convention

You have been hearing about the Texas Garden Club State Convention for several months. You know that the Grapevine Garden Club is hosting and the dates are March 22, 23, and 24. But you would probably like more information about what goes on at the convention.

Texas Garden Clubs, Inc. (TGC) is our state organization. TGC offers its member clubs many things: gardening information; projects to support; schools for a variety of subjects including flower design and environmental studies, scholarships; a quarterly magazine; and many options including making many new friends through gardening. TGC has two yearly conventions, one in the fall and the spring convention we are hosting.

The first two days of the convention are meetings of various TGC committees and officers, but there are events you may find interesting and we would encourage you to attend the following. The complete agenda and registration forms are on our website.

- Starting Friday afternoon, March 23rd at 3:00, we will host a “Garden Party” at our very own Grapevine Botanical Garden for convention guests. There will be tours of the garden and a tea party in the Mitchell House. After the tea, we are hoping that our guests will enjoy some shopping on Main Street. At 5:00, we will be hosting a TGC Cookbook Launch Party and wine reception at the convention center. Dinner will be served there followed by a flower design show titled, “All about Exhibition Tables”.
- Saturday will be a buffet lunch with youth awards. At 2:30, a chartered bus will take convention guests to the Fort Worth Botanical Garden for a dedication of the TGC Headquarters and tea. Saturday evening will be the Awards Dinner Banquet where clubs will be given their awards earned at the state levels.

For those of you wanting to attend convention activities, please use the registration form on our website. GGC members will need to pay for any events they plan to attend, but do not need to pay the \$30 registration fee. Due to limited seating at the Saturday night Awards Banquet, we ask GGC members not to register for this event until after March 15th. Please email Sarah Erickson or Linda Krimm if you would like to attend and you will be contacted if seating becomes available.

Several Grapevine Garden Club members have signed up to help host this convention by doing a variety of tasks to ensure the success of the convention. Some have been assigned tasks already, and others will be given information about their involvement soon. If you have not volunteered, please sign the list at the Sign Up table at the February GGC meeting. If you have any questions, please contact Sarah Erickson.



Texas Garden Club Convention
Garden Party Tea
Grapevine Botanical Gardens (GBG)
411 Ball Street, Grapevine
Friday, March 23 3-5pm



Those of you who were part of the club's 75th Anniversary Tea staged at the Mitchell House at the GBG in 2007 will have a vision of the staging needed for the Garden Party. The decorative theme for the Garden Party will be *Hats Off to Dedicated Gardeners*. You are invited to attend the Garden Party as a guest! However, as a member of the GGC you are technically hosting this event although you may not be scheduled as one of the Garden Party hostesses. So, join us as we welcome gardeners from all over Texas. Enjoy the refreshments being served at the Mitchell House. Wander around the garden and visit with the docents stationed in different areas providing information about how the garden was developed and its use.

How can you help?!

We are trying to save money (minimal budget for the event) by members contributing finger food, punch and products that will be needed.

For the 2007 tea, the GGC rented a **lattice screen**. Do you have a screen that we could borrow for the Garden Party?

Decorations for 6 tables using hats are being created by the decorating committee (Susan Boelens, Angela Ozymy, Valerie Reed and Ann Hogue). Contact Susan Boelens if you have a hat that could be used or a hat/wig stand or a product that could be used as a hat stand. We are considering using flower pots as hat stands.

Finger food provided by members will be served on glass or silver platters which the committee will provide. However, we may need serving utensils for finger foods. Please consider providing sweet and savory finger food for the event.

Please check the sign-up sheets at the general meeting and let us know if you can contribute toward our needs or email/phone Joetta King. Suggestions are welcome!



75th Tea committee setting up (2007)
Need folding screen



75th Tea banquet table (2007)
Need blue net or pink net to pick up
Garden Party logo color

Plan to Party!

“Garden Party - Hats Off to 80 Years of Gardening”
Tuesday, May 22 10:30am-12:30pm

☞ **Valerie Reed, Coordinator**



Do you need a reason to be with friends and enjoy fabulous food? Having enjoyed agreeable weather, delicious food provided by members, and great fellowship at Trawick Pavilion at Grapevine Lake in recent years, members and guests will again gather at that site. This convivial gathering is also an opportunity to acknowledge civic leaders who support the club's activities and to meet the newly elected slate of officers and scholarship recipients for 2012-2013. Luncheon sign-up will begin at the March general meeting.

[Please note that the yearbook date for the spring luncheon, May 15, is not correct.]

Committee members: Ann Hogue, Joan Kowalski, Linda Barraclough, Patricia Mingus, Angela Ozymy, Susan Boelens, Edie Williams, Barbara Munn, Valerie Reed with Noel, René Herndon and Joetta King (photographer).

“We have met the enemy and he is us.....”

Pogo daily strip from Earth Day, 1971, by Walt Kelly

I recently read a book written several years ago by the well-known writer Bill Bryson. In the book, *At Home: A Short History of Private Life*, his lively and inquisitive mind enables him to look closely into the ordinary things of life as found in a comfortable home. The mundane items he writes about are endlessly educational and interesting, at least to me. Here is an excerpt from his chapter entitled “The Garden”:



For many people today, gardening is about lawns and almost nothing else. In the United States lawns cover more surface area – fifty thousand square miles – than any single farm crop. Grass on domestic lawns wants to do what wild grasses do in nature – namely, grow to a height of about two feet, flower, turn brown, and die. To keep it short and green and continuously growing means manipulating it fairly brutally and pouring a lot of stuff onto it. In the western United States about 60 percent of all the water that comes out of taps for all purposes is sprinkled on lawns. Worse still are the amount of herbicides and pesticides – seventy million pounds of them a year – that are soaking into lawns. It is a deeply ironic fact that for most of us keeping a handsome lawn is about the least green thing we do.

☞Elayne Vick



Gardeners on the Go
Creating an Imaginative Garden
Friday, March 30 - Benbrook and Fort Worth



As members strolled with Katie Sherrod through her garden in October, we found whimsical fairy gardens created by her grandchildren. I certainly hope that the hide-and-seek appeal of a fairy garden intrigues you. The GGC will be visiting **Tim's Landscape and Garden Center** where you will have an opportunity to create a small fairy garden with direction from Mary Doebbeling (photo). Supplies to create the fairy garden will be provided for a fee of approximately \$15. (Details regarding supplies will be available to those who express an interest.) Although the fairy garden that we will be creating

might be more appropriate for display on a tabletop, it may captivate children visiting your garden to create diminutive garden furniture from simple sticks, rocks and acorns. Instead of weeds germinating through the garden, you may find a tiny fairy room nestled among the plants. Do you need inspiration or have doubts about these tiny environments? Donni Webber posted the winners of a fairy garden contest on her blog, *The Magic Onions*. Choose a few to view from her long list. They are utterly captivating and provide many ideas for creating these small gardens.

If you are not interested in creating a fairy garden, you will have ample time to browse the extensive collection of plants grown by local independent growers, garden accessories, organics and tools offered at Tim's. The seductive garden center grounds may induce you to simply sit on a garden bench under the massive trees and enjoy chatting with friends.

Following our visit to Tim's, we will dine at the **Lunch Box** before proceeding to **Cherry Richardson's Sanctuary Garden** which was featured during a recent Garden Conservancy Open Days Garden Tour. From the moment you view the bottle tree, roses and Texas-friendly perennials in the front yard, you will realize that this is no ordinary garden. But just wait until you see the hidden garden! It has

evolved during the last nine years to become a year-round haven for Richardson as well as for the butterflies, bees, and birds attracted by the plants, the sound of running water, and the many bird feeders. “The garden is an extension of my house,” Richardson says. “I’d rather be here than in the house. There are things here that entertain me and make me excited about living.” You will be excited too when you see how she has intermingled artifacts and rescued treasures throughout the landscape. Chandeliers in the trees, stained-glass panels hung from the porch eave, and many more repurposed items are displayed in an elegant style.

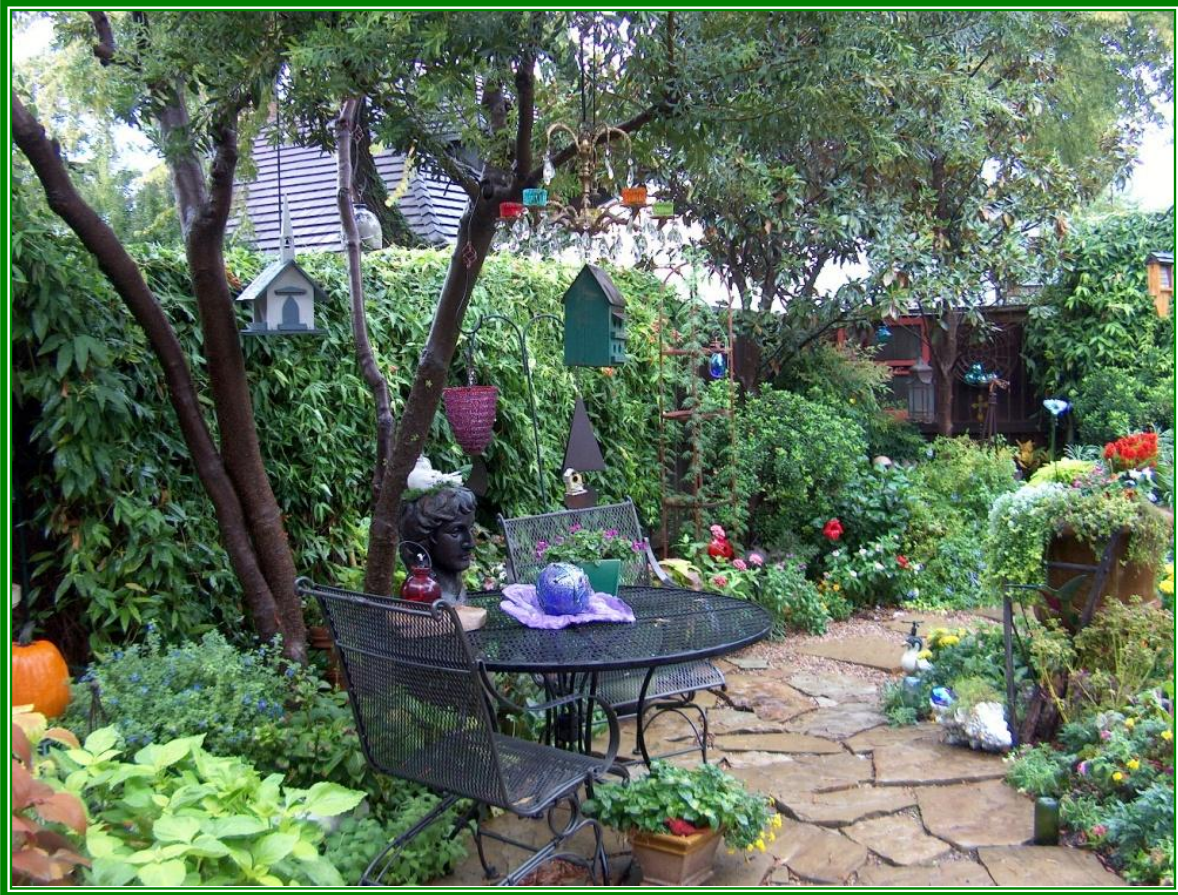

Despite being a small garden, you could spend hours admiring the found art in Richardson’s garden. However, there is another segment to this tour that you will not want to miss! We will be shopping at **Into the Garden**. Take the time to study the interior structure of Into the Garden. This building was the old Crystal Ice House. Exposed brick walls, steel crane, and original gauges still adorn the space and provide a delightful atmosphere for browsing the high-quality outdoor furniture and the amazing selection of accessories. Tour attendees will receive a 15% discount off regular-priced items.

Jon Campbell, better known as Tropical Jon, will present a brief presentation, "Interiorscape: The Containerized Growing of Plants Indoors." Jon stated, "We have a great outdoor season in DFW and therefore a great opportunity to bring the indoors into the garden and then back inside when it's time to do so. Of course, the addition of some seasonal tropical plants, which are suitable for the indoors, add a splash of color, fragrance, and texture, showcasing the vacationing house plants."

Contact Joetta King for further information
and a tour reservation.

✂Joetta King
Gardeners on the Go Coordinator



USDA Unveils New Plant Hardiness Zone Map

WASHINGTON, Jan. 25, 2012—The U.S. Department of Agriculture (USDA) today released the new version of its Plant Hardiness Zone Map (PHZM), updating a useful tool for gardeners and researchers for the first time since 1990 with greater accuracy and detail. The new map—jointly developed by USDA's Agricultural Research Service (ARS) and Oregon State University's (OSU) PRISM Climate Group—is available online at www.planthardiness.ars.usda.gov. ARS is the chief intramural scientific research agency of USDA.

For the first time, the new map offers a Geographic Information System (GIS)-based interactive format and is specifically designed to be Internet-friendly. The map website also incorporates a "find your zone by ZIP code" function. Static images of national, regional and state maps have also been included to ensure the map is readily accessible to those who lack broadband Internet access.

"This is the most sophisticated Plant Hardiness Zone Map yet for the United States," said Dr. Catherine Woteki, USDA Under Secretary for Research, Education and Economics. "The increases in accuracy and detail that this map represents will be extremely useful for gardeners and researchers."



Plant hardiness zone designations represent the average annual extreme minimum temperatures at a given location during a particular time period. They do not reflect the coldest it has ever been or ever will be at a specific location, but simply the average lowest winter temperature for the location over a specified time. Low temperature during the winter is a crucial factor in the survival of plants at specific locations.

The new version of the map includes 13 zones, with the addition for the first time of zones 12 (50-60 degrees F) and 13 (60-70 degrees F). Each zone is a 10-degree Fahrenheit band, further divided into A and B 5-degree Fahrenheit zones.

To help develop the new map, USDA and OSU requested that horticultural and climatic experts review the zones in their geographic area, and trial versions of the new map were revised, based on their expert input.

Compared to the 1990 version, zone boundaries in this edition of the map have shifted in many areas. The new map is generally one 5-degree Fahrenheit half-zone warmer than the previous map throughout much of the United States. This is mostly a result of using temperature data from a longer and more recent time period; the new map uses data measured at weather stations during the 30-year period 1976-2005. In contrast, the 1990 map was based on temperature data from only a 13-year period of 1974-1986.

Some of the changes in the zones, however, are a result of new, more sophisticated methods for mapping zones between weather stations. These include algorithms that considered for the first time such factors as changes in elevation, nearness to large bodies of water, and position on the terrain, such as valley bottoms and ridge tops. Also, the new map used temperature data from many more stations than did the 1990 map. These advances greatly improved the accuracy and detail of the map, especially in mountainous regions of the western United States. In some cases, advances resulted in changes to cooler, rather than warmer, zones.

While about 80 million American gardeners, as well as those who grow and breed plants, are the largest users of the USDA Plant Hardiness Zone Map, many others need this hardiness zone information. For example, the USDA Risk Management Agency uses the USDA plant hardiness zone designations to set some crop insurance standards. Scientists use the plant hardiness zones as a data layer in many research models such as modeling the spread of exotic weeds and insects.

Although a poster-sized version of this map will not be available for purchase from USDA, as in the past, anyone may download the map free of charge from the Internet onto their personal computer and print copies of the map as needed.

